

Single Pole/3-Way Push Button Dimmer

EDM25

120V 60Hz

150W
LED/CFL

300W
INC/HAL

Help

Find more information:

www.elegrp.com/support/document-center/fyler

Email: support@elegrp.com
(Email Feedback in 24 hours)

Call us:
U.S.A | Canada
866-267-3272

Product Introduction

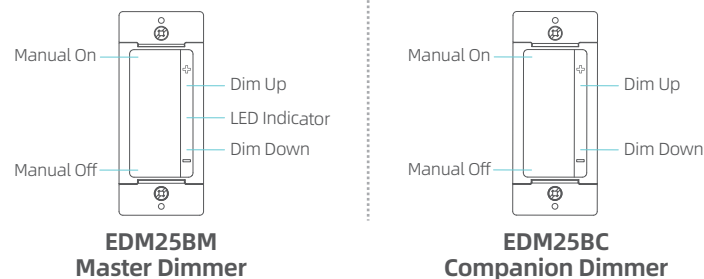

Features

- Modern Architectural-Style Large Tapswitch Dimmer Designed for standard designer wallplate openings.
- Product Highlights: Multi-Location Dimming Control. Works with Companion Dimmer.
- Allows you to dim/brighten or switch on/off the lights from 2+ locations.
- No Neutral Wire Required. Easy installation in both new and retrofit applications.
- Advanced Dimming Technology. Broad compatibility with high-efficacy bulbs: Dimmable LEDs, Halogen, and Incandescent (ETL Listed).
- Custom Adjustments Low-end/High-end Trim: Optimize brightness range for any bulb type.
- Adjustable LED Indicator: Personalize indicator brightness to ambient preferences.
- Tapswitch Memory Function. Automatically restores lights to previous brightness level upon activation.
- Sleek Aesthetic Integration. Pair with coordinating screwless wallplates for a seamless modern look.
- 100% Factory-Tested Reliability. Ensures consistent performance and durability.

Single Pole Wiring

1 Determine wiring type

For lights switched from two location(3-Way), see instructions on the reverse side.

For lights switched from one location(Single Pole), proceed to Step 2.

2 Turn power OFF at circuit breaker

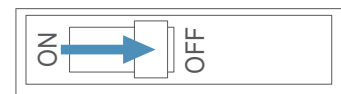

WARNING: SHOCK HAZARD. May cause serious injury or death. Turn off power at circuit.

3 Disconnect old switch and connect dimmer switch

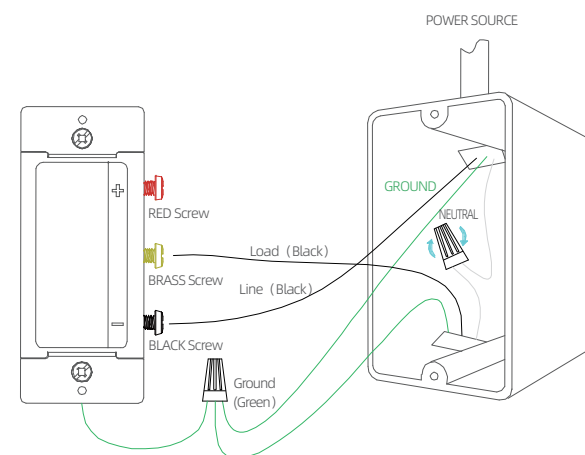

IMPORTANT: Do not connect Red Screw in single pole wiring.

4 Turn power ON at circuit breaker

- The indicator LED will be turned on once power has been restored.

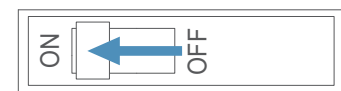

5 Installation is complete!

3-Way Wiring

1 Turn power OFF at circuit breaker



WARNING: SHOCK HAZARD. May cause serious injury or death. Turn off power at circuit breaker or fuse before installation.

2 Mark wire on the COMMON terminal

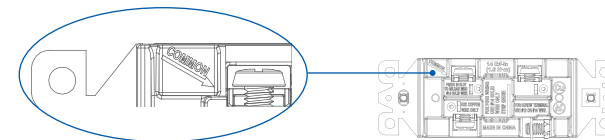

- Remove (but do not disconnect) existing devices
- Before disconnecting the existing devices, tag the wire connected to the black screw (typically labeled COM, but wire colors vary). This is the Common wire.

3 Determine 3 way wiring type

- If connected the new Master dimmer (EDM25BM) and OTHER EXISTING switch, follow the instruction 4A;
- If connected the new Master dimmer (EDM25BM) and Companion Dimmer (EDM25BC), follow the instruction 4B.

4A Connect MASTER dimmer and EXITING switch

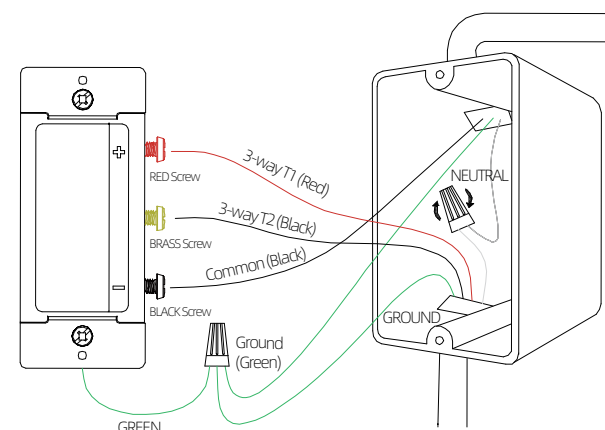

One Location

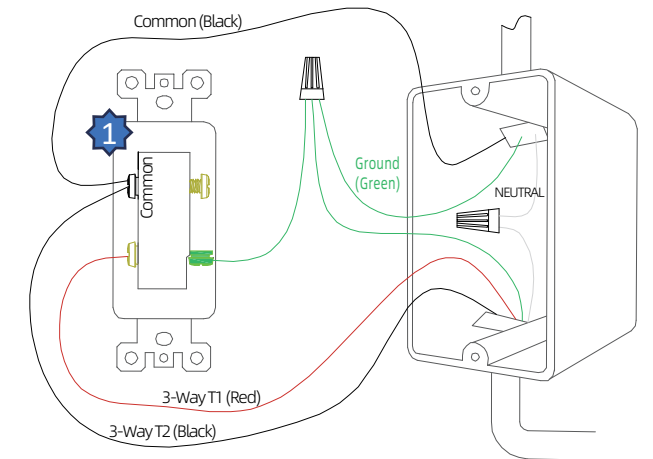

Re-Wiring Another Location

1. Connect 2 black wires(one from line, one from traveler) to common terminal in mechanical switch (different color screw).

4B Connect MASTER dimmer and COMPANION dimmer

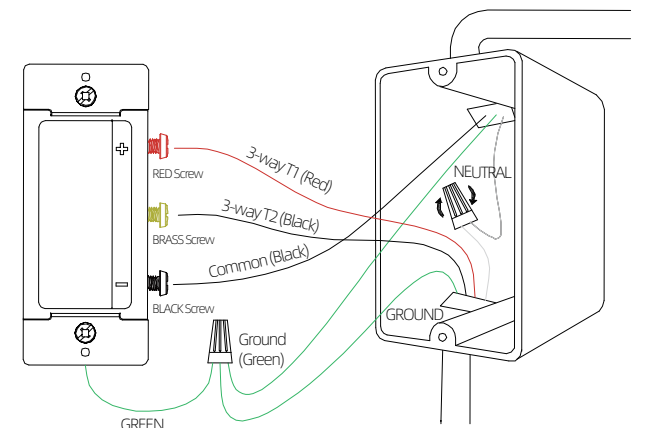

Both Two Location

IMPORTANT:

- 1.Connect Common Line (normally Black line) to Black screw on the Master Dimmer, do same connection for Companion Dimmer.
- 2.Connect 3-Way T1 Line (normally Red line) to Red screw on the Master Dimmer, do same connection for Companion Dimmer.

5 Turn power ON at circuit breaker

The indicator LED will be turned on once power has been restored.

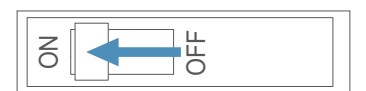

6 Installation is complete!

Troubleshooting

Symptom	Solution
Light have poor dimming performance	Adjust low-end Trim or high-end trim to improve, otherwise contact with customer service.
LED indicator off	Based on program setting, While Load light is on, LED indicator is off; while Load light is off, LED indicator is on. Brightness of LED indicator is set to OFF, follow instruction about setting LED indicator brightness, setting LED indicator brightness to maximum brightness.

Adjust Low-end Trim

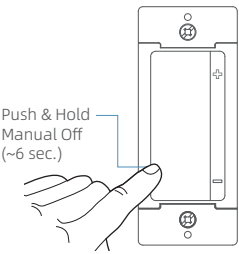

1. Push and hold Manual **OFF** button on the master dimmer (EDM25BM) until the indicator LED begins to flash (~6 sec.).
2. Push dim up button(+) and dim down button(-) to improve lowest dimming range where lights are on and stable.
3. Tap the Manual OFF button to save.

Adjust High-end Trim

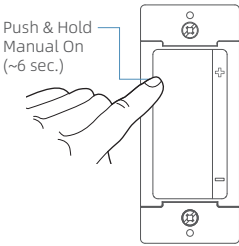

1. Push and hold Manual **On** button on the master dimmer (EDM25BM) until the indicator LED begins to flash (~6 sec.).
2. Push dim up button(+) and dim down button (-) to improve highest dimming range where lights are on and stable.
3. Tap the Manual OFF button to save.

Set LED Indicator Brightness

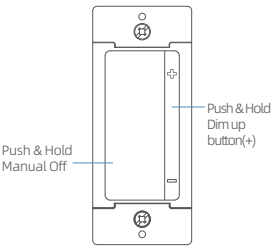

1. First, Push & hold Manual OFF button on the master dimmer (EDM25BM), then, Push & hold dim up button (+) until the indicator LED begins to flash (~6 sec.).
2. Push dim up button(+) and dim down button(-) to adjust LED indicator brightness to what you like.
3. Tap the Manual OFF button to save.

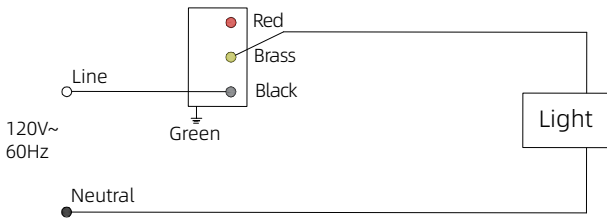

Single Pole Wiring

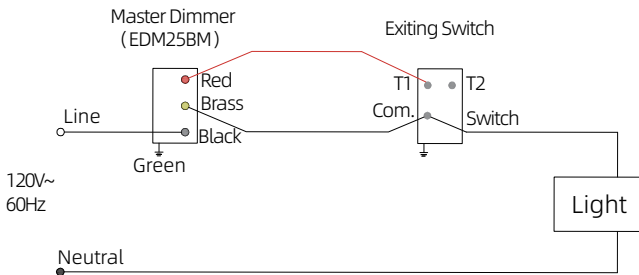

MASTER dimmer + EXITING switch in 3 Way Wiring

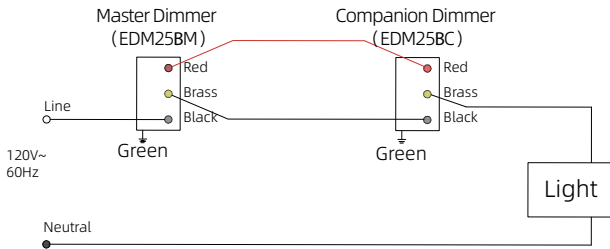

MASTER dimmer + COMPANION dimmer in 3 Way Wiring

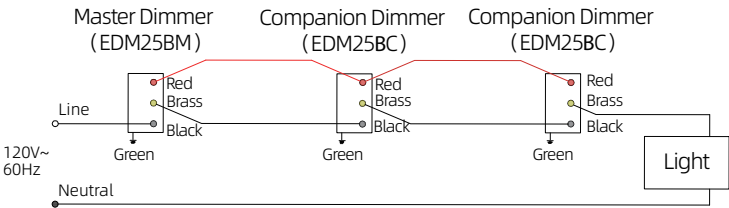

MASTER dimmer + COMPANION dimmer in 4 Way Wiring

ELE GROUP CO., LTD

NO.158 CHUANGYUAN ROAD, SIP
SUZHOU, JIANGSU, CHINA 215125

Important

- **CAUTION:** To Reduce The Risk of Overheating and Possible Damage to Other Equipment, **Do Not** Install to Control a Receptacle, a Motor-Operated Appliance or a Fluorescent Lighting Fixture or a Transformer Supplied Appliance.
- For control of permanently installed fixtures with dimmable screw-in compact fluorescent, dimmable screw-in LED, halogen, or incandescent lamps.
- Install in accordance with all national and local electrical codes.
- It is normal for the dimmer to feel warm to the touch during operation.
- For indoor use only. Operate between 32 °F and 104 °F (0 °C and 40 °C).
- Clean with a soft damp cloth only. DO NOT use any chemical cleaners.
- Device rating for INC/HAL is 300W in single gang. 2-gang use derating to 250W, 3-gang use derating to 200W.

Important

- **ATTENTION:** Pour réduire le risque de surchauffe et d'endommagement d'autres équipements, **NE PAS** utiliser pour contrôler des prises de courant, des appareils à moteur ou des appareils alimentés par un transformateur.
- Pour contrôler des luminaires installés de façon permanente avec des lampes fluorescentes compactes à vis graduables, des LED à vis graduables, des lampes halogènes ou des lampes à incandescence.
- Installer conformément à tous les codes électriques nationaux et locaux.
- Il est normal que le gradateur soit chaud au toucher pendant son fonctionnement.
- Pour une utilisation à l'intérieur uniquement. Fonctionne entre 32 °F et 104 °F (0 °C et 40 °C).
- Nettoyer avec un chiffon doux et humide uniquement. N'utilisez PAS de nettoyeurs chimiques.
- La puissance nominale du dispositif pour les ampoules à incandescence (INC) / halogènes (HAL) est de 300 watts pour un boîtier monogang. En cas d'utilisation de boîtiers à 2 gorges, la puissance est dégradée à 250 watts, et pour les boîtiers à 3 gorges, la puissance est dégradée à 200 watts.

FCC Compliance Statement

This device complies with part 15 of the FCC Rules. Operation is subject to the following two conditions: (1) This device may not cause harmful interference, and (2) this device must accept any interference received, including interference that may cause undesired operation.

FCC Caution: Any Changes or modifications not expressly approved by the party responsible for compliance could void the user's authority to operate the equipment.

Note: The manufacturer is not responsible for any radio or TV interference caused by unauthorized modifications to this equipment. Such modifications could void the user's authority to operate the equipment. This equipment has been tested and found to comply with the limits for a Class B digital device, pursuant to part 15 of the FCC Rules. These limits are designed to provide reasonable protection against harmful interference in a residential installation. This equipment generates, uses and can radiate radio frequency energy and, if not installed and used in accordance with the instructions, may cause harmful interference to radio communications. However, there is no guarantee that interference will not occur in a particular installation. If this equipment does cause harmful interference to radio or television reception, which can be determined by turning the equipment off and on, the user is encouraged to try to correct the interference by one or more of the following measures:

- Reorient or relocate the receiving antenna.
- Increase the separation between the equipment and receiver.
- Connect the equipment into an outlet on a circuit different from that to which the receiver is connected.
- Consult the dealer or an experienced radio/TV technician for help.

One Year Limited Warranty

The warranty gives you specific rights and you may also have other rights, which vary in different states and countries. Our company warrants to the original consumer purchaser that this product is free of defects in materials and workmanship for 1 year from the purchase date. This warranty does not cover labor for removal or reinstallation of the product and is void on any product installed improperly or in an improper environment, overloaded, misused, opened, abused, or altered in any manner. Our company excludes incidental or consequential damages for breach of any warranty on this product. Some jurisdictions may not allow limitations on how long an implied warranty lasts or the exclusion or limitation of incidental or consequential damages, so the above exclusions or limitations may not apply to you.