

# Installation Instruction

Smart Rotary Dimmer Switch  
3-Way

**ELEGRP**

## PRODUCT INTRODUCTION

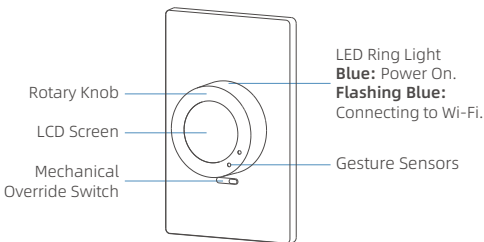

Smart Rotary Dimmer Switch

## KNOB OPERATION

	Press	Rotate	Press & Hold
Switch	On/Off	Control brightness	/
Setting	Confirm options	Shift options	Enter or exit the setting menu

## TOOLS NEEDED



Flat-Head  
Screwdriver



Phillips  
Screwdriver

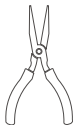

Wire Strippers  
(recommended)



Test Pencil  
(recommended)

# WHAT'S IN THE BOX

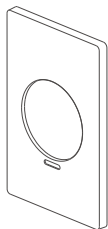

Dedicated Face Plate

Knob Screws



Rotary Knob



Dedicated  
Fixing Plate

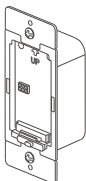

Dimmer  
Switch Base



Do not force to pull out the knob before removing the knob screws, otherwise the device will be destroyed.



2 x Crescent Plate Kits  
\* For compatible with the  
NEMA standard decorative  
wall plate.



2 x Wall Plate Screws  
2 x Mounting Screws  
(Pre-installed)



Wire Labels



Wire Connectors

# CHECK COMPATIBILITY

**Rating:** 120VAC, 60Hz

**Operating Temperature:** 0°C~40°C (32°F~104°F)

**Storage Temperature:** -20°C~70°C (-4°F~158°F)

**Wiring Type:** 3-way

**LCD Resolution:** 240\*240 dpi

## Compatible Bulb Types and Max Load



Dimmable LED  
150W



Dimmable CFL  
150W



Incandescent  
450W

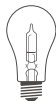

Halogen  
450W

Due to the larger size of the rotary knob, it is not feasible to install rotary dimmer switches side by side in a multi-gang wall plate.

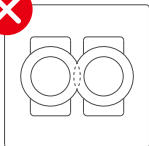
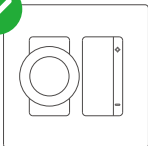

**The white neutral wire is required to connect.** The device will not function if the neutral wire is not connected.

## BEFORE WE START



**⚠ WARNINGS:** To avoid fire, shock, or death, **turn off power at circuit breaker or fuse** and test that the power is off before wiring!

**⚠ CAUTIONS:** To reduce the risk of overheating and possible damage to other equipment, **DO NOT** install to control a receptacle, a motor operated appliance, a fluorescent lighting fixture, or a transformer-supplied appliance.

**⚠ AVERTISSEMENTS:** Pour éviter le feu, les chocs ou la mort, **éteignez le disjoncteur ou le fusible** et vérifiez que l'alimentation est coupée avant le câblage!

**⚠ ATTENTIONS:** Pour réduire le risque de surchauffe et d'endommagement possible d'autres équipements, **NE PAS** installer pour contrôler une prise, un appareil actionné par moteur, un appareil d'éclairage fluorescent ou un appareil alimenté par un transformateur.



**Consult a qualified electrician** if you are unfamiliar with electrical codes and regulations, or are uncomfortable performing the installation.

## REMOVE WALL PLATE

Determine the type of wall plate your smart rotary dimmer switch is going to be installed with (different in opening shapes):

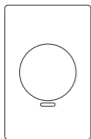

Dedicated Wall Plate (supplied)

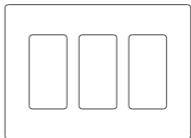
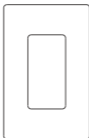

NEMA Standard Decorative Wall Plate

a) If your smart rotary dimmer switch is going to be installed with the **dedicated wall plate (special for this ELEGRP smart rotary dimmer switch)**:

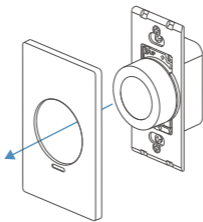

Push a flat-head screwdriver into the slot at the bottom of the dedicated face plate. Gently pry apart to remove the face plate.

b) If your smart rotary dimmer switch is going to be installed with a **NEMA standard decorative wall plate (the same opening size as wall plates from any brand)**:

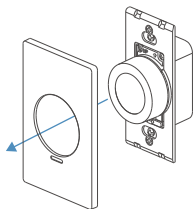

1. Push a flat-head screwdriver into the slot at the bottom of the dedicated faceplate. Gently pry apart to remove the face plate.

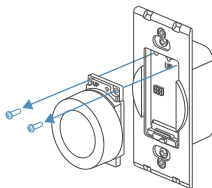

2. Use a Philips screwdriver to remove the screws from the rotary knob and then remove the rotary knob itself.

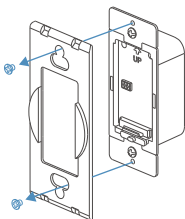

3. Use a Philips screwdriver to remove wall plate screws and dedicated fixing plate.

## REMOVE OLD SWITCH

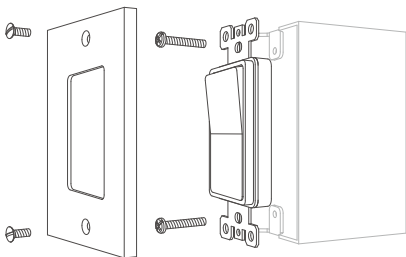

After power is turned off, remove wall plate and switch mounting screws. Carefully pull out the old switch from the wall box (do not remove wires).



### Turn Off Power

Before removing, turn off power at circuit breaker or fuse and use a test pencil to confirm whether power is off before wiring or servicing fixture!



# IDENTIFY THE TYPE OF CIRCUIT

Power Source

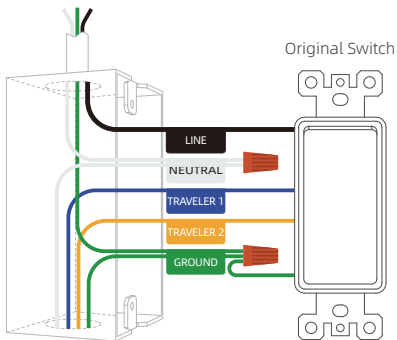

To Load (Fixture)

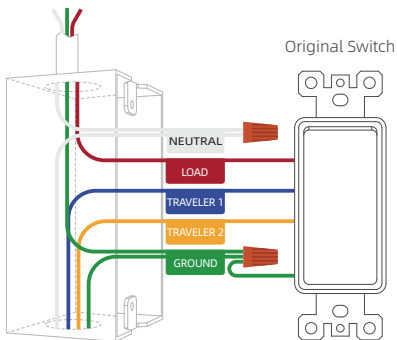

Wire Label	Line	Load	Neutral	Ground	Traveler T1	Traveler T2
Wire Color	Black	Red or Black	White	Green or Bare Copper	unknown	unknown

1. Turn ON the power from circuit breaker and switch OFF the light(s).
2. Turn on the test pencil and pass it through the wires connected to **the common terminals (usually black)** in each wall box. Blinking and beeping indicate **Line wire** from the wall box to Power Source. The non-response wire is the **Load wire** from the wall box to Load (Fixture).
3. Pass the test pencil through the other traveler terminals (usually brass) from each wall box. Blinking and beeping indicate **Traveler 1**. The non-response wire is **Traveler 2**.
4. **Turn OFF the power** from circuit breaker. Label the Line, Load, Traveler 1 and Traveler 2 wires from each wall box as previously identified.
5. Label the Neutral wire and Ground wire in each wall box. Neutral wires are usually white, and Ground wires are usually green / bare copper.



This smart device should be installed in the wall box that is connected to the **Load (Fixture)** and has a **NEUTRAL** wire (usually white) available.

## WIRING DIAGRAM FOR PRO

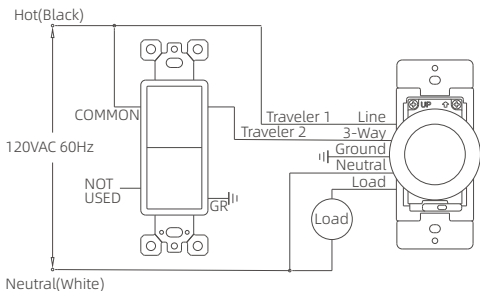

If the Neutral wire exists in the wall box to Power Source only, and the wiring in the wall box does not resemble any of these configurations, check this wiring diagram and consult a qualified electrician.

## DISCONNECT THE SWITCH TO LOAD

Disconnect the switch from the wall box to Load (Fixture). Do not remove the original switch from the wall box connected to Power Source.

## STRIP WIRES



Make sure that the ends of the wires from the wall box are straight (cut if necessary).

Remove 0.6" (15mm) of insulation from each wire in the wall box.

## HOW TO USE WIRE CONNECTORS

# CONNECT WIRES

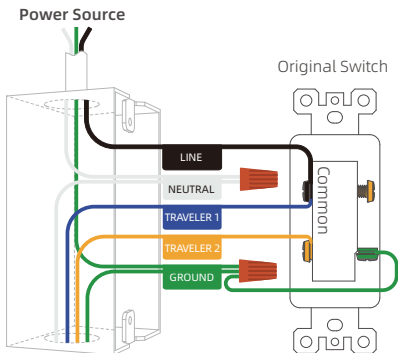

## To Load (Fixture)

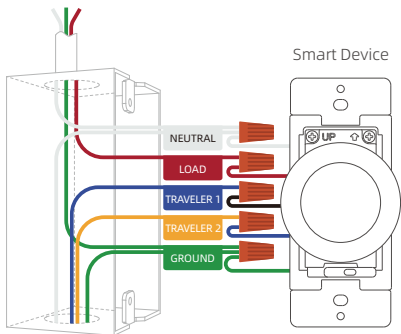

### **For the original 3-way switch in the location connected to the Power Source**

1. Disconnect the Traveler 1 from the original 3-way switch.
2. Connect the Traveler 1 to the terminal screw on the switch marked "Common" , where there was a black wire labeled "Line" .

### **For the smart switch in the location connected to the Load (Fixture)**

1. Check the wire identifications from the back of the smart device.
2. Match every labeled wire from the wall box with the wires of the smart device.
3. Screw on the provided wire connectors clockwise to connect wires.



If the smart device is installed in a single-pole circuit, do not connect the 3-way wire of the smart device.

## FINISH WIRING

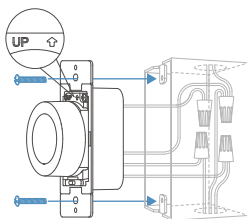

Form all wires carefully into wall box, and mount switch with mounting screws supplied.  
(\*The rotary knob may have been removed. )



### Important

Do not mount the switch upside down.

## MOUNT WALL PLATE

a) If your smart rotary dimmer switch is going to be installed with the **dedicated wall plate (special for this ELEGRP smart rotary dimmer switch)**:

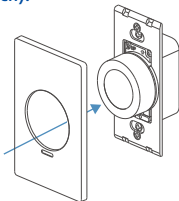

Push the dedicated face plate onto the dedicated fixing plate and snap it into place.

b) If your smart rotary dimmer switch is going to be installed with a **NEMA standard decorative wall plate** (the same opening size as wall plates from any brand):

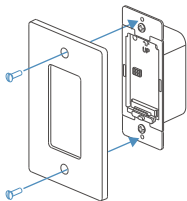

1. Use the wall plate screws to mount the NEMA standard decorative wall plate.

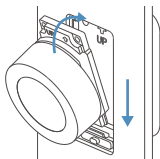

2. Insert the rotary knob into the bottom slot. Push the knob in.

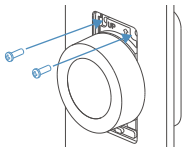

3. Screw the knob with the torque values within 9.0 in-lbf (1.0 N·m).

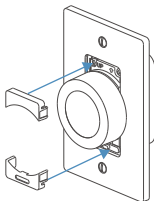

4. Push one crescent plate with a mechanical override switch hole into the bottom slot, and another into the top slot around the rotary knob. Snap them securely into place.



# TROUBLESHOOTING

## After installation, the switch does not turn on?

- If the LCD screen does not light up
  - Check if the circuit breaker or fuse is connected properly.
  - Try swapping your Line and Load wires.
- If the LCD screen lights up
  - Check that the bulb is properly installed and has not failed.

## Difficulty in connecting smart switch to a Wi-Fi network?

- Make sure the Wi-Fi network is a 2.4 GHz network.
- The Wi-Fi connection may not have good coverage. Try moving your Wi-Fi router closer to the smart switch.

## What should I do when the bulb is flickering?

This dimmer switch has been set by default to dim a broad range of dimmable LED, CFL, incandescent and halogen lights. However, the dimming range of dimmable CFLs and LEDs can vary from bulb to bulb.

- a) If the flickering only happens at low brightness range, please set the minimum brightness to a higher level where the bulbs light up without flickering.
  - On the Smart Rotary Dimmer Switch: Press and hold the rotary knob to enter the setting menu. Rotate the knob to select "Set Minimum Brightness" and press to confirm. Then you can adjust the minimum brightness by rotating the knob.
  - In the ELEGRP HOME App: Tap your smart rotary dimmer switch and then go to "Configure-Set Minimum Brightness".
- b) If the flickering happens during the whole dimming range, please make sure you are using dimmable bulbs or consider replacing your bulb(s) with a different model.



Refer to help center in the app for additional troubleshooting suggestions

# HAVING PROBLEMS? WE CAN HELP!

Email: [support@elegroup.com](mailto:support@elegroup.com)

Call us on: 866-267-3272 Mon-Fri 9:00-17:00 EST (US)

Feel free to contact us with any questions or concerns. Our customer service team will work hard to put a smile back on your face.

## About Us

Website: [www.elegroup.com](http://www.elegroup.com)

Search ELEGRP on social media